

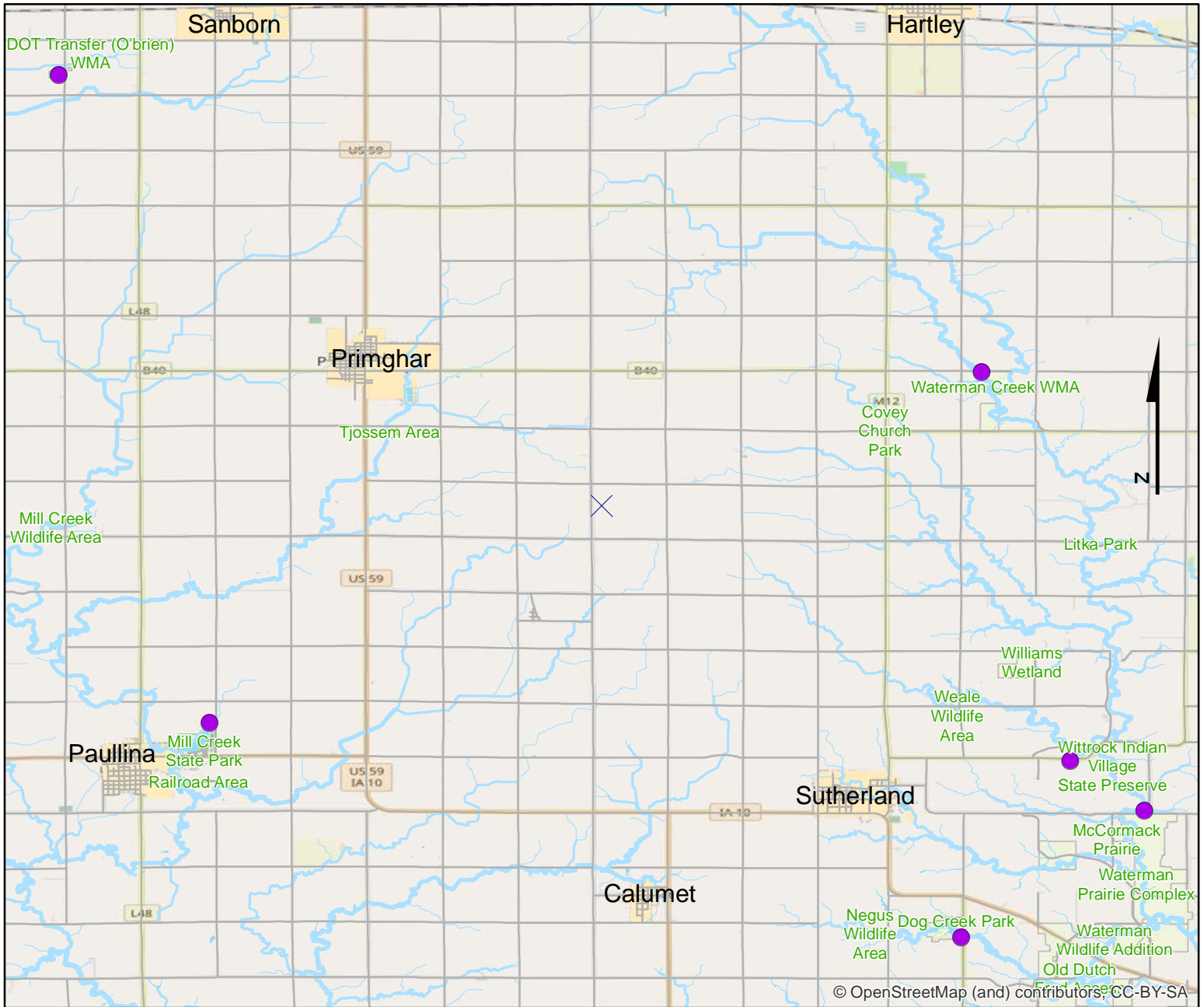

Volunteer Wildlife Monitoring Program (VWMP) Frog and Toad Survey

Route ID: 139 County: O'Brien

Click for Google Maps to Site 1: <https://www.google.com/maps/dir/?api=1&destination=43.084229,-95.461822>



© OpenStreetMap (and) contributors CC-BY-SA

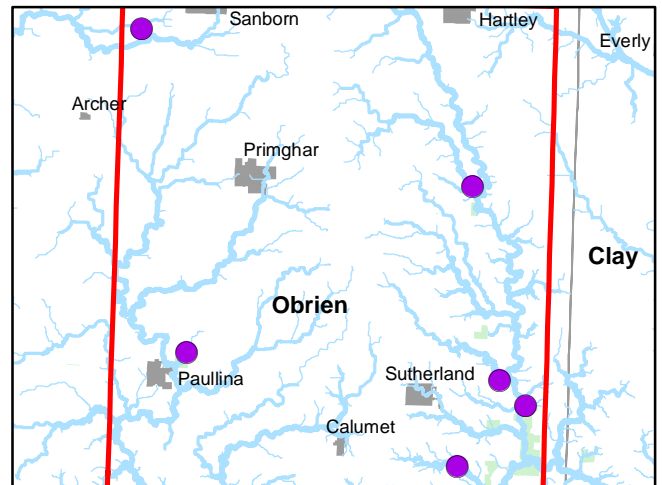
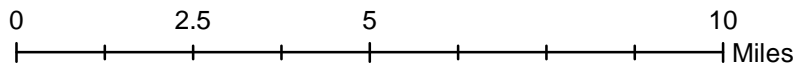

Questions? Contact the VWMP Coordinator at wmp@dnr.iowa.gov. Created on:3/4/2021

Volunteer Wildlife Monitoring Program (VWMP) Frog and Toad Survey



Route ID: 139 County: O'Brien

Click for Google Maps to Site 1: <https://www.google.com/maps/dir/?api=1&destination=43.084229,-95.461822>

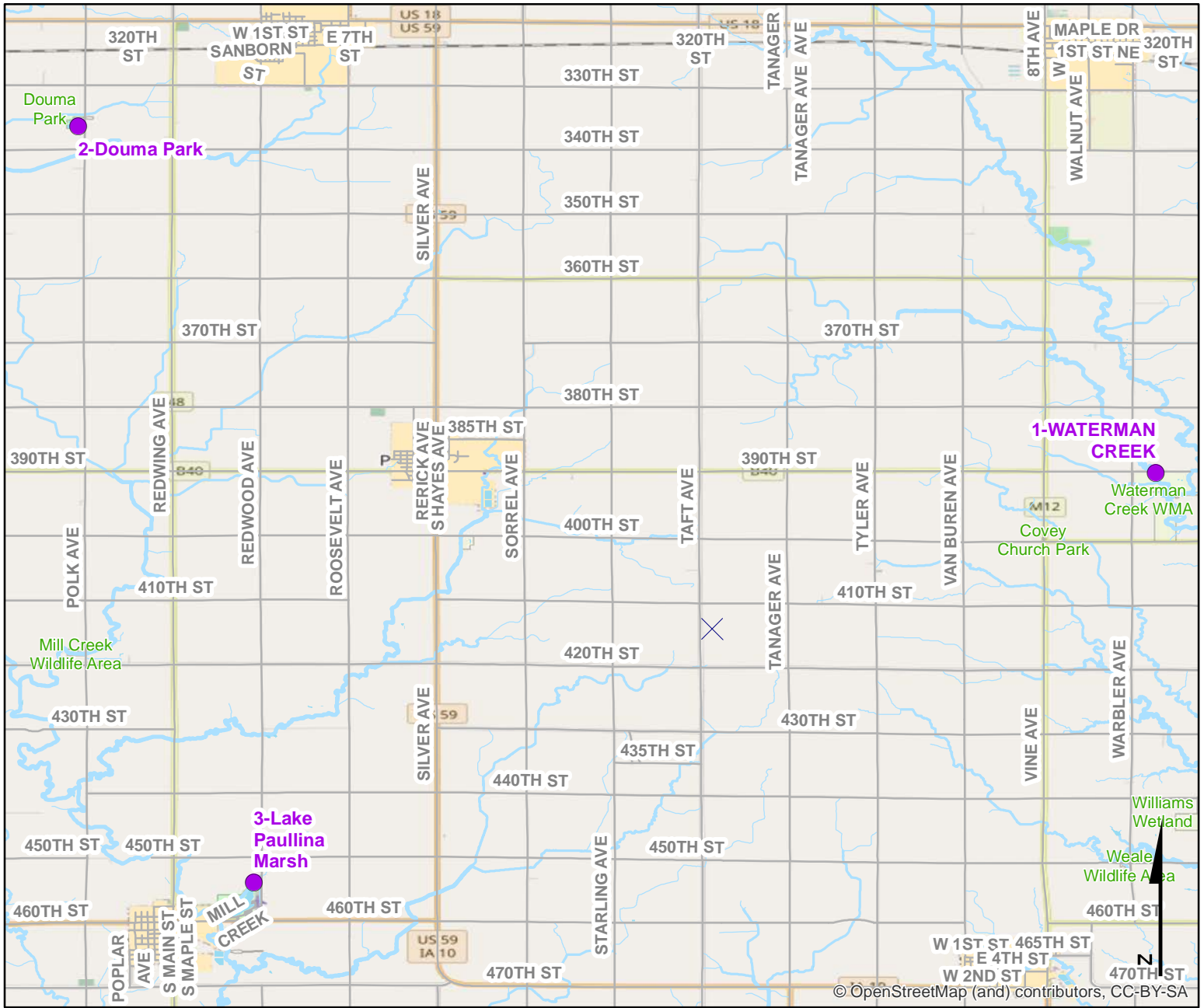

© OpenStreetMap (and) contributors, CC-BY-SA

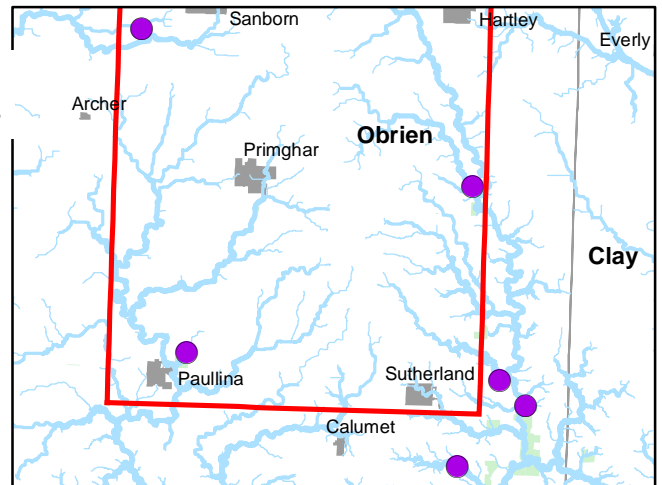
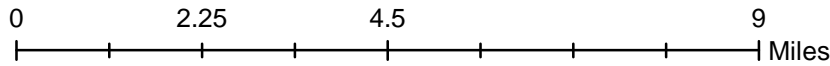

Volunteer Wildlife Monitoring Program (VWMP) Frog and Toad Survey



Route ID: 139 County: O'Brien

Click for Google Maps to Site 1: <https://www.google.com/maps/dir/?api=1&destination=43.084229,-95.461822>

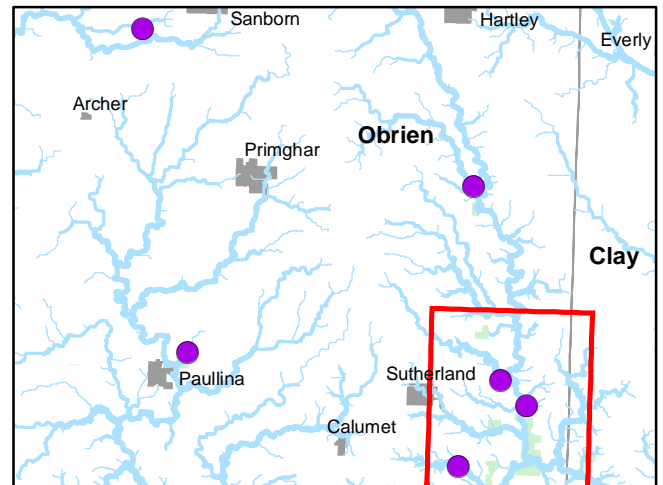
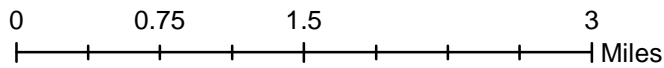
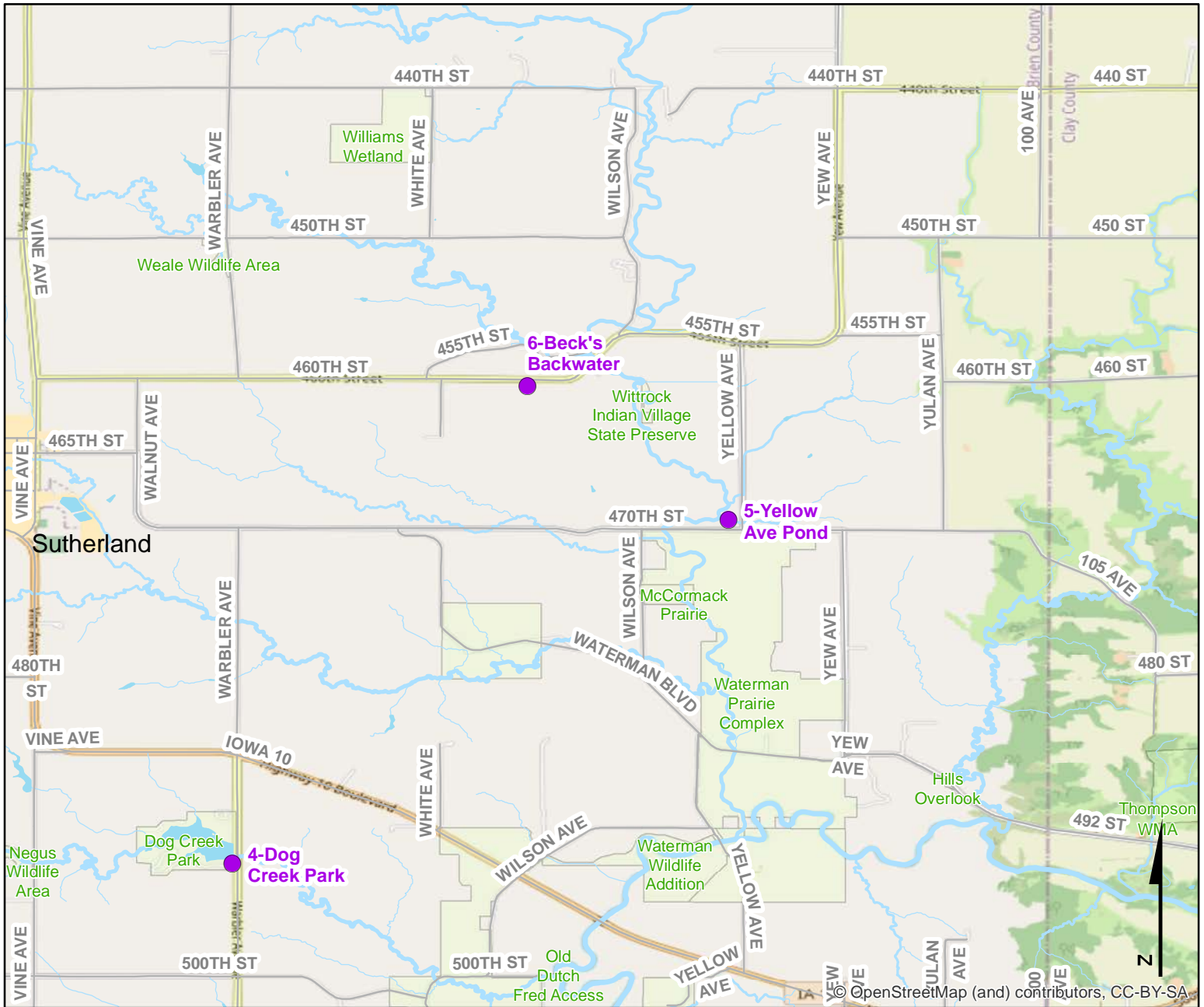

Questions? Contact the VWMP Coordinator at vwmp@dnr.iowa.gov. Created on: 3/4/2021



Frog and Toad Call Survey Route Description

Route ID **139**

Established: 1994

Site Number	Name	County	Latitude	Longitude	Directions
1	WATERMAN CREEK	O'Brien	43.0842294	-95.4618224	1/4 miles east of Warbler Ave and 390th St on bridge over Waterman Creek
2	Douma Park	O'Brien	43.1624053	-95.7049153	
3	Lake Paullina Marsh	O'Brien	42.9917682	-95.6652776	Marsh on Source end (north) of artificial lake
4	Dog Creek Park	O'Brien	42.9354054	-95.4671569	Listen from the SE corner of lake next to parking area. Dog Creek Park is off of Warbler Ave.
5	Yellow Ave Pond	O'Brien	42.9687699	-95.4189659	
6	Beck's Backwater	O'Brien	42.981817	-95.4384995	